

YE3L Series Super High Efficiency Aluminum Frame Three Phase Induction Motors

➤ General Description



- Frame sizes: 63 to 160
- Voltage: 380V
- Poles: 2, 4, 6, 8
- Duty Cycle: S1
- Insulation class: F
- Insulation class: F
- Rated output: 0.12 to 18.5kW
- Frequency: 50Hz or 60Hz
- Efficiency levels: IE3
- Enclosure: IC411 - TEFC
- Degree of protection: IP56 / IP65
- Degree of protection: IP55

Applications: General purpose including cutting machines, pumps, fans, conveyors, machines tools of farm duty and food process.

Features: Beautiful profile, high efficiency and energy saving (Level 2 of GB18613-2012), class F insulation, IP55 protection grade, low noise, little vibration, reliable running.

➤ Performance Data

380V 50Hz

Model	Output kW	FLA	RPM	Eff.%	Power Factor	FLT N.m	$\frac{LRT}{FLT} \frac{Tst}{T_N}$	$\frac{LRA}{FLA} \frac{Ist}{I_N}$	$\frac{BDT}{FLT} \frac{Tmax}{T_N}$	dB(A)
Synchronous speed 3000 r/min										
YE3L-63M1-2	0.18	0.53	2720	63.9	0.80	0.63	2.2	5.5	2.2	61
YE3L-63M2-2	0.25	0.70	2720	67.1	0.81	0.88	2.2	5.5	2.2	61
YE3L-71M1-2	0.37	1.0	2740	69.0	0.81	1.29	2.2	6.1	2.2	62
YE3L-71M2-2	0.55	1.4	2740	72.3	0.82	1.92	2.2	6.1	2.2	62
YE3L-80M1-2	0.75	1.7	2870	80.7	0.82	2.50	2.2	7.0	2.3	62
YE3L-80M2-2	1.1	2.4	2875	82.7	0.83	3.65	2.2	7.3	2.3	62
YE3L-90S-2	1.5	3.2	2880	84.2	0.84	4.97	2.2	7.6	2.3	67
YE3L-90L-2	2.2	4.6	2880	85.9	0.85	7.30	2.2	7.6	2.3	67
YE3L-100L-2	3	6.0	2880	87.1	0.87	9.95	2.2	7.8	2.3	74
YE3L-112M-2	4	7.8	2915	88.1	0.88	13.1	2.2	8.3	2.3	77
YE3L-132S1-2	5.5	10.6	2935	89.2	0.88	17.9	2.0	8.3	2.3	79
YE3L-132S2-2	7.5	14.4	2930	90.1	0.88	24.4	2.0	7.9	2.3	79
YE3L-160M1-2	11	20.6	2950	91.2	0.89	35.6	2.0	8.1	2.3	81
YE3L-160M2-2	15	27.9	2945	91.9	0.89	48.6	2.0	8.1	2.3	81
YE3L-160L-2	18.5	34.2	2945	92.4	0.89	60.0	2.0	8.2	2.3	81

Performance Data

380V 50Hz

Model	Output kW	FLA	RPM	Eff. %	Power Factor	FLT N.m	$\frac{LRT}{FLT}$ $\frac{Tst}{T_N}$	$\frac{LRA}{FLA}$ $\frac{Ist}{I_N}$	$\frac{BDT}{FLT}$ $\frac{Tmax}{T_N}$	dB(A)
Synchronous speed 1500 r/min										
YE3L-63M1-4	0.12	0.45	1310	55.8	0.72	0.87	2.1	4.4	2.2	52
YE3L-63M2-4	0.18	0.64	1310	58.6	0.73	1.31	2.1	4.4	2.2	52
YE3L-71M1-4	0.25	0.81	1330	63.6	0.74	1.80	2.1	5.2	2.2	55
YE3L-71M2-4	0.37	1.1	1330	65.3	0.75	2.66	2.1	5.2	2.2	55
YE3L-80M1-4	0.55	1.4	1430	80.6	0.75	3.67	2.3	6.5	2.3	56
YE3L-80M2-4	0.75	1.8	1430	82.5	0.75	5.01	2.3	6.6	2.3	56
YE3L-90S-4	1.1	2.6	1430	84.1	0.76	7.35	2.3	6.8	2.3	59
YE3L-90L-4	1.5	3.5	1430	85.3	0.77	10.0	2.3	7.0	2.3	59
YE3L-100L1-4	2.2	4.8	1440	86.7	0.81	14.6	2.3	7.6	2.3	64
YE3L-100L2-4	3	6.3	1440	87.7	0.82	19.9	2.3	7.6	2.3	64
YE3L-112M-4	4	8.4	1455	88.6	0.82	26.3	2.2	7.8	2.3	65
YE3L-132S-4	5.5	11.2	1465	89.6	0.83	35.9	2.0	7.9	2.3	71
YE3L-132M-4	7.5	15.0	1465	90.4	0.84	48.9	2.0	7.5	2.3	71
YE3L-160M-4	11	21.5	1470	91.4	0.85	71.5	2.0	7.7	2.3	73
YE3L-160L-4	15	28.8	1470	92.1	0.86	97.4	2.0	7.8	2.3	73

Synchronous speed 1000 r/min										
YE3L-71M1-6	0.18	0.76	850	54.6	0.66	2.02	1.9	4.0	2.0	52
YE3L-71M2-6	0.25	0.97	850	57.4	0.68	2.81	1.9	4.0	2.0	52
YE3L-80M1-6	0.37	1.2	910	68.0	0.70	3.88	1.9	5.5	2.0	54
YE3L-80M2-6	0.55	1.6	925	72.0	0.71	5.68	1.9	5.8	2.1	54
YE3L-90S-6	0.75	2.0	945	78.9	0.71	7.58	2.0	6.0	2.1	57
YE3L-90L-6	1.1	2.8	950	81.0	0.73	11.1	2.0	6.0	2.1	57
YE3L-100L-6	1.5	3.8	950	82.5	0.73	15.1	2.0	6.5	2.1	61
YE3L-112M-6	2.2	5.4	965	84.3	0.74	21.8	2.0	6.6	2.1	65
YE3L-132S-6	3	7.2	975	85.6	0.74	29.4	1.9	6.8	2.1	69
YE3L-132M1-6	4	9.5	975	86.8	0.74	39.2	1.9	6.8	2.1	69
YE3L-132M2-6	5.5	12.7	975	88.0	0.75	53.9	1.9	7.0	2.1	69
YE3L-160M-6	7.5	16.2	980	89.1	0.79	73.1	1.9	7.0	2.1	70
YE3L-160L-6	11	23.1	980	90.3	0.80	107	1.9	7.2	2.1	70

Performance Data

380V 50Hz

Model	Output kW	FLA	RPM	Eff.%	Power Factor	FLT N.m	$\frac{LRT}{FLT}$ $\frac{Tst}{T_N}$	$\frac{LRA}{FLA}$ $\frac{Ist}{I_N}$	$\frac{BDT}{FLT}$ $\frac{Tmax}{T_N}$	dB(A)
Synchronous speed 750 r/min										
YE3L-80M1-8	0.18	0.8	700	56.0	0.61	2.46	1.8	3.3	1.9	52
YE3L-80M2-8	0.25	1.1	700	59.0	0.61	3.41	1.8	3.3	1.9	52
YE3L-90S-8	0.37	1.4	695	66.0	0.61	5.08	1.8	4.0	1.9	56
YE3L-90L-8	0.55	2.0	695	70.0	0.61	7.56	1.8	4.0	2.0	56
YE3L-100L1-8	0.75	2.3	705	73.5	0.67	10.2	1.8	4.0	2.0	59
YE3L-100L2-8	1.1	3.2	705	76.5	0.69	14.9	1.8	5.0	2.0	59
YE3L-112M-8	1.5	4.2	715	77.5	0.70	20.0	1.8	5.0	2.0	61
YE3L-132S-8	2.2	5.9	730	80.0	0.71	28.8	1.8	6.0	2.2	64
YE3L-132M-8	3	7.6	730	82.5	0.73	39.2	1.8	6.0	2.2	64
YE3L-160M1-8	4	9.8	725	85.0	0.73	52.7	1.9	6.0	2.2	68
YE3L-160M2-8	5.5	13.1	725	86.0	0.74	72.4	1.9	6.0	2.2	68
YE3L-160L-8	7.5	17.4	730	87.5	0.75	98.1	1.9	6.0	2.2	68

Dimensions & Mounting

mm

B14 (Footless and Small Flange Mounted)

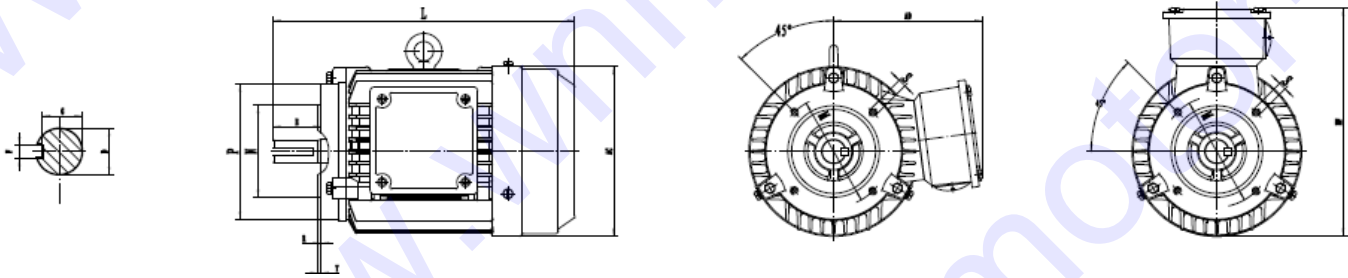

Frame	Poles	Mounting Dimension										Overall Dimension			
		D	E	F	G	M	N	P	R	S	T	AC	AD	HF	L
63M	2,4	11	23	4	8.5	75	60	90	0	4-M5	2.5	135	70	140	230
71M	2,4,6	14	30	5	11	85	70	105	0	4-M6	2.5	145	80	160	255
80M	2,4,6,8	19	40	6	15.5	100	80	120	0	4-M6	3	165	145	225	295
90S	2,4,6,8	24	50	8	20	115	95	140	0	4-M8	3	180	165	255	345
90L	2,4,6,8														385
100L	2,4,6,8	28	60	8	24	130	110	160	0	4-M8	3.5	205	175	275	390
112M	2, 6, 8	28	60	8	24	130	110	160	0	4-M8	3.5	225	190	300	425
	4														455

B34 (Foot and Small Flange Mounted)

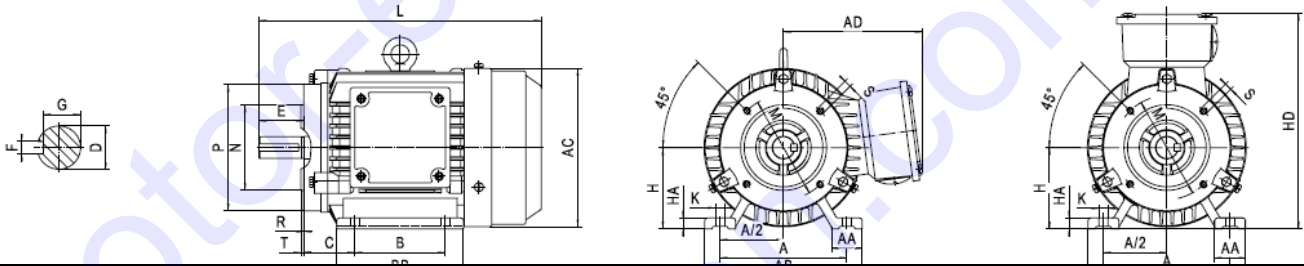

Frame	Poles	Mounting Dimension														Overall Dimension								
		A	B	C	D	E	F	G	H	K	M	N	P	R	S	T	AA	BB	HA	AB	AC	AD	HD	L
63M	2,4	100	80	40	11	23	4	8.5	63	7	75	60	90	0	4-M5	2.5	30	110	8	135	135	70	180	230
71M	2,4,6	112	90	45	14	30	5	11	71	7	85	70	105	0	4-M6	2.5	32	120	8	150	145	80	195	255
80M	2,4,6,8	125	100	50	19	40	6	15.5	80	10	100	80	120	0	4-M6	3	32	135	10	160	165	145	225	295
90S	2,4,6,8	140	100	56	24	50	8	20	90	10	115	95	140	0	4-M8	3	34	170	12	180	180	165	255	345
90L	2,4,6,8		125															210						385
100L	2,4,6,8	160	140	63	28	60	8	24	100	12	130	110	160	0	4-M8	3.5	39	186	14	200	205	175	275	390
112M	2, 6,8	190	140	70	28	60	8	24	112	12	130	110	160	0	4-M8	3.5	45	200	14	230	225	190	300	425
	4																	230						455

B3 (Horizontal Foot Mounted Only)

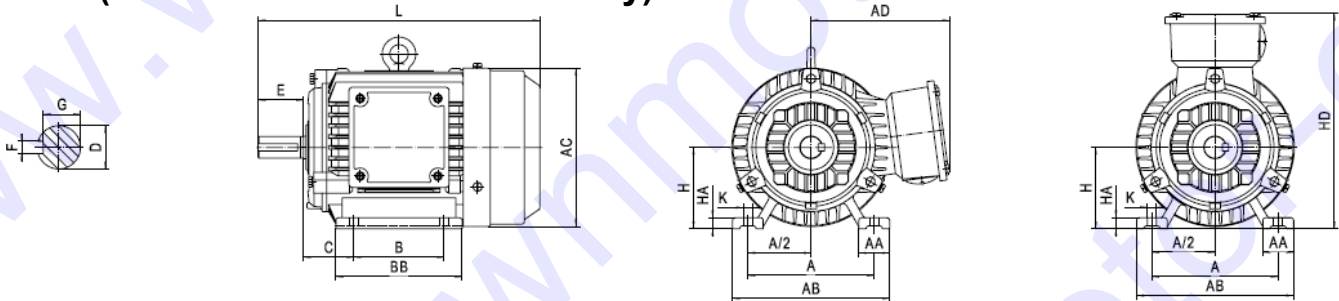

Frame	Poles	Mounting Dimension											Overall Dimension						
		A	B	C	D	E	F	G	H	K	AA	BB	HA	AB	AC	AD	HD	L	
63M	2,4	100	80	40	11	23	4	8.5	63	7	30	110	8	135	135	70	180	230	
71M	2,4,6	112	90	45	14	30	5	11	71	7	32	120	8	150	145	80	195	255	
80M	2,4,6,8	125	100	50	19	40	6	15.5	80	10	32	135	10	160	165	145	225	295	
90S	2,4,6,8	140	100	56	24	50	8	20	90	10	34	170	12	180	180	165	255	345	
90L			125									210						385	
100L	2,4,6,8	160	140	63	28	60	8	24	100	12	39	186	14	200	205	175	275	390	
112M	2, 6,8	190	140	70	28	60	8	24	112	12	45	200	14	230	225	190	300	425	
	4											230						455	
132S	2,4,6,8	216	140	89	38	80	10	33	132	12	55	190	18	265	270	220	350	475	
132M			178									230						510	
160M	2,4,6,8	254	210	108	42	110	12	37	160	15	65	260	20	315	320	260	420	610	
160L			254									304						655	

B5 (Footless and B5 Flange Mounted)

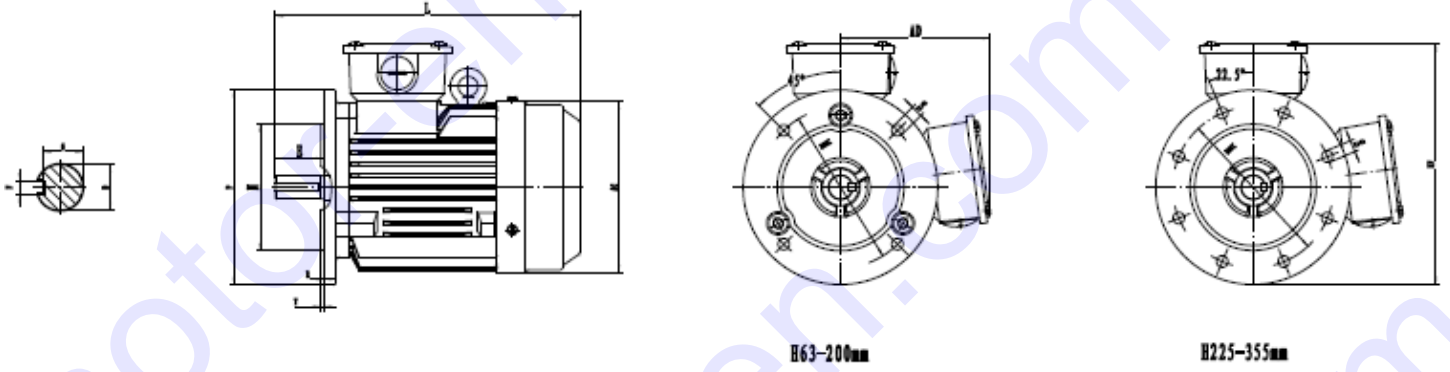

Frame	Poles	Mounting Dimension										Overall Dimension			
		D	E	F	G	M	N	P	R	S	T	AC	AD	HF	L
63M	2,4	11	23	4	8.5	115	95	140	0	4-Φ10	3	135	70	140	230
71M	2,4,6	14	30	5	11	130	110	160	0	4-Φ10	3.5	145	80	160	255
80M	2,4,6,8	19	40	6	15.5	165	130	200	0	4-Φ12	3.5	165	145	245	295
90S	2,4,6,8	24	50	8	20	165	130	200	0	4-Φ12	3.5	180	165	265	345
90L															385
100L	2,4,6,8	28	60	8	24	215	180	250	0	4-Φ15	4	205	175	300	390
112M	2,6,8	28	60	8	24	215	180	250	0	4-Φ15	4	225	190	315	425
	4														455
132S	2,4,6,8	38	80	10	33	265	230	300	0	4-Φ15	4	270	220	370	475
132M															510
160M	2,4,6,8	42	110	12	37	300	250	350	0	4-Φ19	5	320	260	435	610
160L															655

B35 (Foot and B5 Flange Mounted)

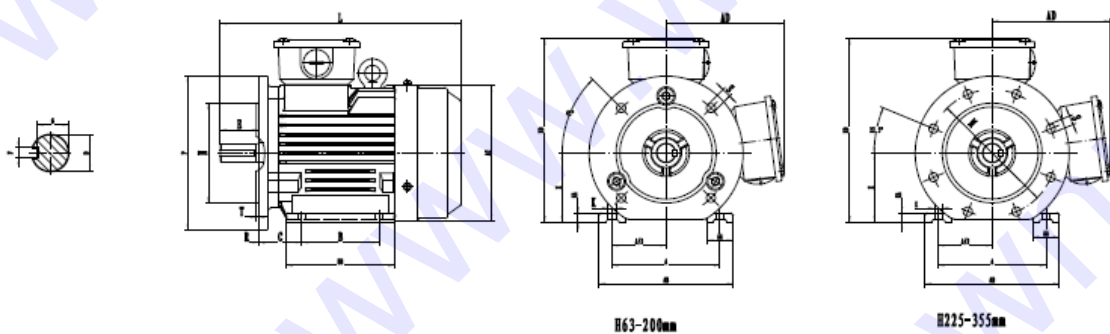

Frame	Poles	Mounting Dimension															Overall Dimension							
		A	B	C	D	E	F	G	H	K	M	N	P	R	S	T	AA	BB	HA	AB	AC	AD	HD	L
63M	2,4	100	80	40	11	23	4	8.5	63	7	115	95	140	0	4-Φ10	3	30	110	8	135	135	70	180	230
71M	2,4,6	112	90	45	14	30	5	11	71	7	130	110	160	0	4-Φ10	3.5	32	120	8	150	145	80	195	255
80M	2,4,6,8	125	100	50	19	40	6	15.5	80	10	165	130	200	0	4-Φ12	3.5	32	135	10	160	165	145	225	295
90S	2,4,6,8	140	100	56	24	50	8	20	90	10	165	130	200	0	4-Φ12	3.5	34	170	12	180	180	165	255	345
90L			125															210						385
100L	2,4,6,8	160	140	63	28	60	8	24	100	12	215	180	250	0	4-Φ15	4	39	186	14	200	205	175	275	390
112M	2,6,8	190	140	70	28	60	8	24	112	12	215	180	250	0	4-Φ15	4	45	200		230	225	190	300	425
	4																	230	455					
132S	2,4,6,8	216	140	89	38	80	10	33	132	12	265	230	300	0	4-Φ15	4	55	190	18	265	270	220	350	475
132M																		178						230
160M	2,4,6,8	254	210	108	42	110	12	37	160	15	300	250	350	0	4-Φ19	5	65	260	20	315	320	260	420	610
160L																		254						304

V1 (Vertical Shaft down Footless Flange Mounted)

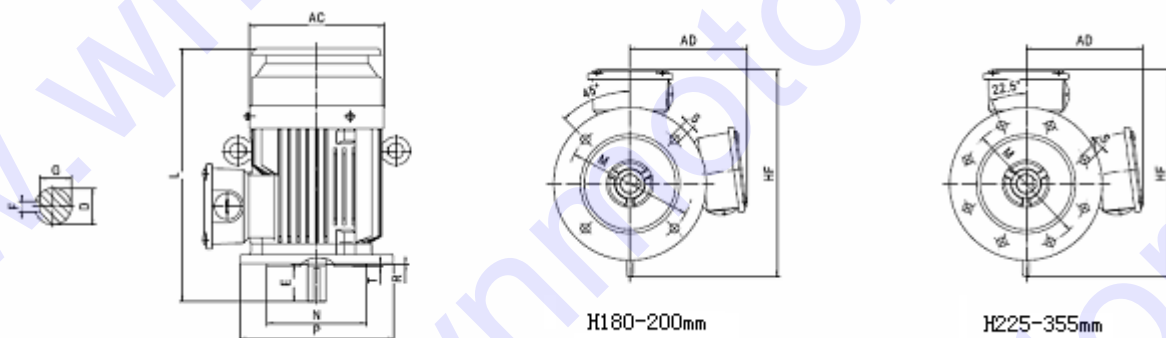

Frame	Poles	Mounting Dimension											Overall Dimension			
		D	E	F	G	M	N	P	R	S	T	AC	AD	HF	L	
80M	2,4,6,8	19	40	6	15.5	165	130	200	0	4-Φ12	3.5	165	145	245	315	
90S	2,4,6,8	24	50	8	20	165	130	200	0	4-Φ12	3.5	180	165	265	370	
90L															410	
100L	2,4,6,8	28	60	8	24	215	180	250	0	4-Φ15	4	205	175	300	420	
112M	2,6,8	28	60	8	24	215	180	250	0	4-Φ15	4	225	190	315	455	
	4														485	
132S	2,4,6,8	38	80	10	33	265	230	300	0	4-Φ15	4	270	220	370	510	
132M															550	
160M	2,4,6,8	42	110	12	37	300	250	350	0	4-Φ19	5	320	260	435	655	
160L															700	

YE3LL series motor with 2 shaft ends, dimensions as follows: mm

B14 (Footless and Small Flange Mounted)

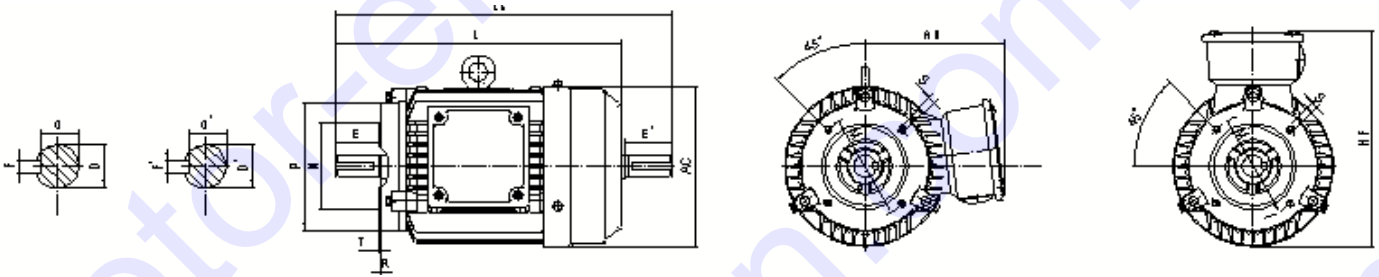

Frame	Poles	Mounting Dimension											Overall Dimension				
		D/D'	E/E'	F/F'	G/G'	M	N	P	R	S	T	AC	AD	HF	L	LC	
80M	2,4,6,8	19	40	6	15.5	100	80	120	0	4-M6	3	165	145	245	290	333	
90S	2,4,6,8	24	50	8	20	115	95	140	0	4-M8	3	180	165	265	340	393	
90L	2,4,6,8														380	433	
100L	2,4,6,8	28	60	8	24	130	110	160	0	4-M8	3.5	205	175	300	385	448	
112M	2,6,8	28	60	8	24	130	110	160	0	4-M8	3.5	225	190	315	420	483	
	4														450	513	

B34 (Foot and Small Flange Mounted)

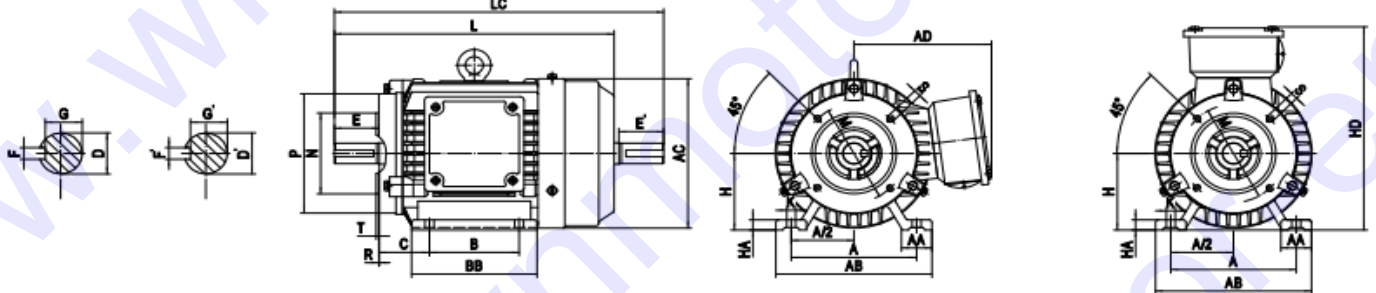

Frame	Poles	Mounting Dimension														Overall Dimension									
		A	B	C	D/D'	E/E'	F/F'	G/G'	H	K	M	N	P	R	S	T	AA	BB	HA	AB	AC	AD	HD	L	LC
80M	2,4,6,8	125	100	50	19	40	6	15.5	80	10	100	80	120	0	4-M6	3	32	135	10	160	165	145	225	290	333
90S	2,4,6,8	140	100	56	24	50	8	20	90	10	115	95	140	0	4-M8	3	34	170	12	180	180	165	255	340	393
90L	2,4,6,8		125															210						380	433
100L	2,4,6,8	160	140	63	28	60	8	24	100	12	130	110	160	0	4-M8	3.5	39	186	14	200	205	175	275	385	448
112M	2,6,8	190	140	70	28	60	8	24	112	12	130	110	160	0	4-M8	3.5	45	200	14	230	225	190	300	420	483
	4																	230						450	513

B3 (Horizontal Foot Mounted Only)

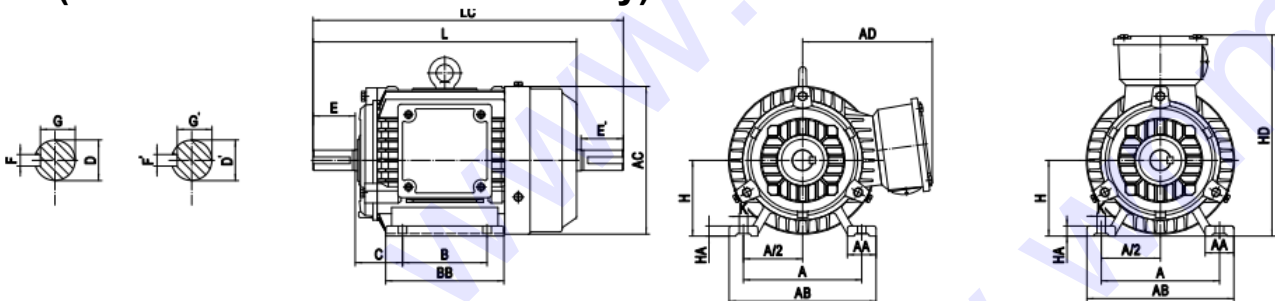



皖南电机
Dimensions

mm

Frame	poles	Mounting Dimension											Overall Dimension										
		A	B	C	D	D'	E	E'	F	F'	G	G'	H	K	AA	BB	HA	AB	AC	AD	HD	L	LC
80M	2.4.6.8	125	100	50	19	19	40	40	6	6	15.5	15.5	80	10	32	135	10	160	165	145	225	290	333
90S	2.4.6.8	140	100	56	24	24	50	50	8	8	20	20	90	10	34	145	12	180	180	165	255	340	393
90L	2.4.6.8		125													170						380	433
100L	2.4.6.8	160	140	63	28	28	60	60	8	8	24	24	100	12	39	186	14	200	205	175	275	385	448
112M	2.6.8	190	140	70	28	28	60	60	8	8	24	24	112	12	45	200	14	230	225	190	300	420	483
	4																					450	513
132S	2.4.6.8	216	140	89	38	38	80	80	10	10	33	33	132	12	55	190	18	265	270	220	350	470	551
132M	2.4.6.8		178													230						505	589
160M	2.4.6.8	254	210	108	42	42	110	110	12	12	37	37	160	15	65	260	20	315	320	260	420	605	719
160L	2.4.6.8		254													304						650	763

B5 (Footless and B5 Flange Mounted)

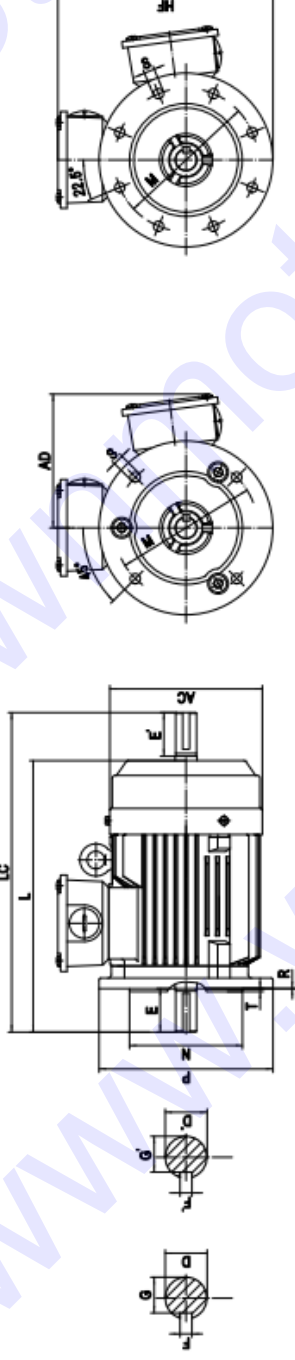

Frame	Poles	Mounting Dimension										H225-280mm					Overall Dimension				
		D	D'	E	E'	F	F'	G	G'	M	N	P	R	S	T	AC	AD	HF	L	LC	
80M	2,4,6,8	19	19	40	40	6	6	15.5	15.5	165	130	200	0	4-Φ12	3.5	165	145	245	290	333	
	2,4,6,8	24	24	50	50	8	8	20	20	165	130	200	0	4-Φ12	3.5	180	165	265	340	393	
	2,4,6,8	28	28	60	60	8	8	24	24	215	180	250	0	4-Φ15	4	205	175	300	380	433	
112M	2,6,8	28	28	60	60	8	8	24	24	215	180	250	0	4-Φ15	4	225	190	315	420	483	
	4	38	38	80	80	10	10	33	33	265	230	300	0	4-Φ15	4	270	220	370	470	551	
160M	2,4,6,8	42	42	110	110	12	12	37	37	300	250	350	0	4-Φ19	5	320	260	435	605	719	
	4	42	42	110	110	12	12	37	37	300	250	350	0	4-Φ19	5	320	260	435	650	763	

B35 (Foot and B5 Flange Mounted)

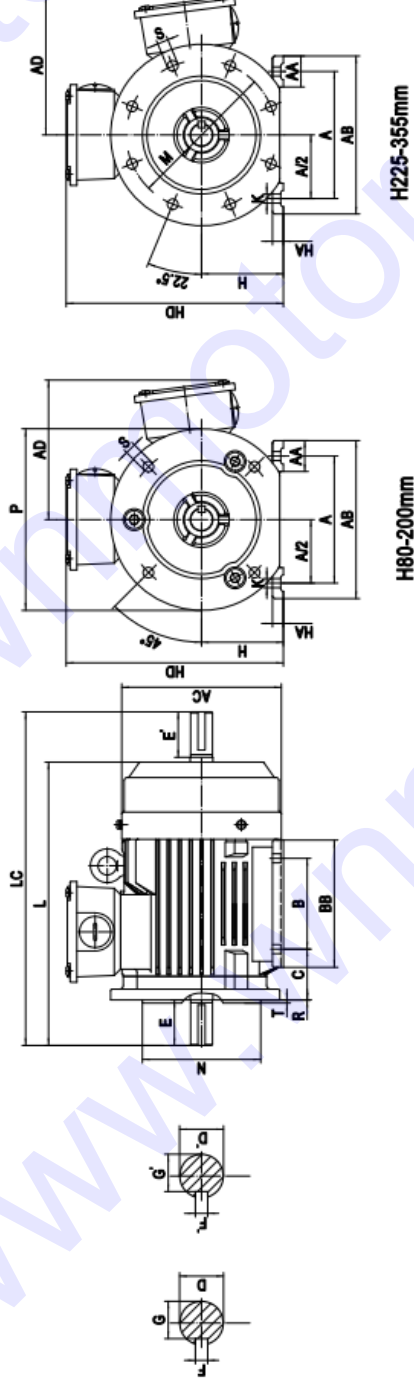

Frame	Poles	Mounting Dimension																		Overall Dimension									
		A	B	C	D	D'	E	E'	F	F'	G	G'	H	K	M	N	P	R	S	T	AA	BB	HA	AB	AC	AD	AD	HD	L
80M	2,4,6,8	125	100	50	19	19	40	40	6	6	15.5	15.5	80	10	165	130	200	0	4-Φ12	3.5	32	135	10	160	165	145	225	290	333
90S	2,4,6,8	140	100	56	24	24	50	50	8	8	20	20	90	10	165	130	200	0	4-Φ12	3.5	34	170	12	180	180	165	255	340	393
90L			125																			210					380	433	
100L	2,4,6,8	160	140	63	28	28	60	60	8	8	24	24	100	12	215	180	250	0	4-Φ15	4	39	186		200	205	175	275	385	448
112M	2,6,8	190	140	70	28	28	60	60	8	8	24	24	112	12	215	180	250	0	4-Φ15	4	45	200	14	230	225	190	300	420	483
	4																					230					450	513	
132S	2,4,6,8	216	140	89	38	38	80	80	10	10	33	33	132	12	265	230	300	0	4-Φ15	4	55	190	18	265	270	220	350	470	551
132M			178																			230					505	589	
160M	2,4,6,8	254	210	108	42	42	110	110	12	12	37	37	160	15	300	250	350	0	4-Φ19	5	65	260	20	315	320	260	420	605	719
160L			254																			304					650	763	

Conventional mounting type and suitable frame size are given in following table (with “√”)

Frame	basic type			derived type											
	B3	B5	B35	V1	V3	V5	V6	B6	B7	B8	V15	V36	B14	B34	V18
63~112	√	√	√	√	√	√	√	√	√	√	√	√	√	√	√
132~160	√	√	√	√	√	√	√	√	√	√	√	√	-	-	-

If there is no other request in the order or agreement, terminal box standard position is at the right side of the frame; data above may be changed without prior notice.